

## 4 - Studs & Components

### Swage Studs

- HFG303 Stud-Cap - 7/8" ID x 5.5" Red
- 964 Stud - 7/16" (11 mm) Swage
- 965 Stud - 1/2" Swage
- 978 Stud - 12 mm Swage

### Sta-Lok Studs

- HFG303 Stud-Cap - 7/8" ID x 5.5" Red
- 966 Stud - 7/16" (11 mm) Sta-Lok
- HFG323 Wedge - 7/16" (11 mm) Sta-Lok
- HFS132 Washer - 1/2" .062 x .531 x 1.250 18-8 FW
- 967 Stud - 1/2" Sta-Lok
- HFG320 Wedge - 1/2" Sta-Lok
- HFS132 Washer - 1/2" .062 x .531 x 1.250 18-8 FW
- 979 Stud 12 mm Sta-Lok
- HFG321 Wedge - 12 mm Sta-Lok
- HFS132 Washer - 1/2" .062 x .531 x 1.250 18-8 FW

### Rod

- HFG303 Stud-Cap - 7/8" ID x 5.5" Red
- 970-22 Stud -22 Rod Adpt w/Nosepiece
- HFG316 Stud - Main Body
- HFG317 Nosepiece -22
- HFG319 Cotter Pin - 3/32" x 1.750" 18-8
- 970-30 Stud -30 Rod Adpt w/Nosepiece
- HFG316 Stud - Main Body
- HFG318 Nosepiece -30
- HFG319 Cotter Pin - 3/32" x 1.750" 18-8

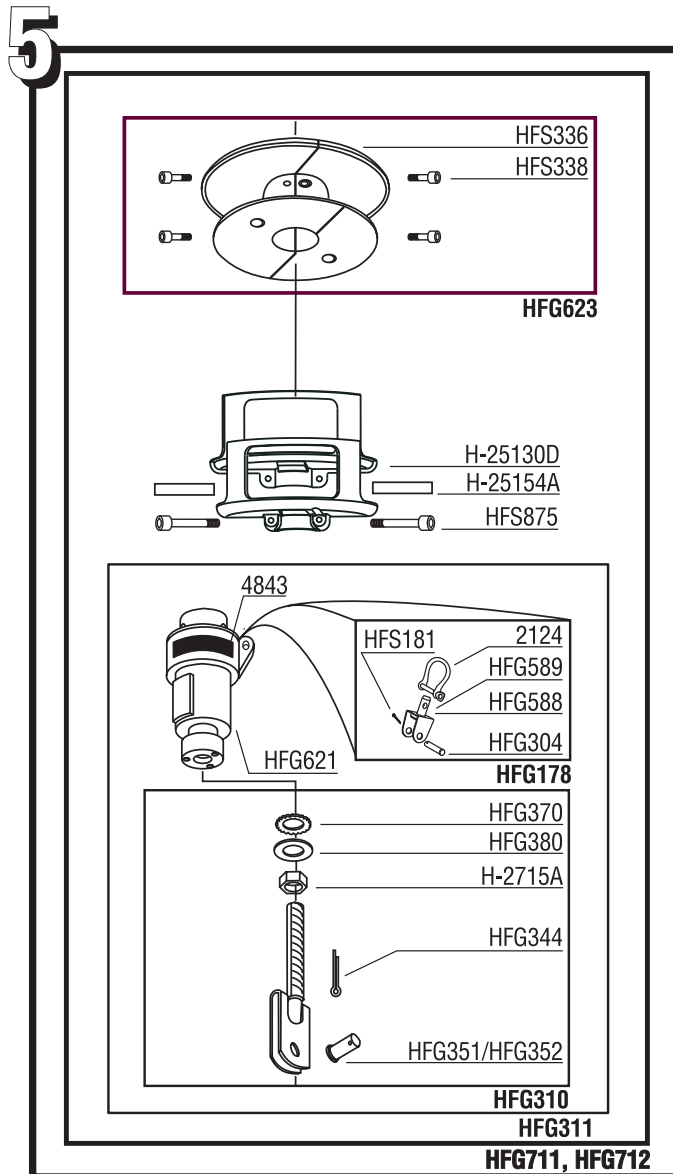

## 5 - Drum Assembly & Components

- HFG711 Drum Assembly 3/4" Clevis - Complete
- HFG712 Drum Assembly 7/8" Clevis - Complete
- HFG622 Cowling - Guard & Spool
- HFG623 Spool Assembly - Complete
- HFS336 M8 x 1.25X16 A4 SK Cap (4)
- HFS338 M4 X 8 18-8 PH OV (2)
- HFG624 Cowling - w/Guard
- H-18100C Cowling
- 4779 Label - Cowling
- HFS332 Fastener - M4 X .7 X 8mm 18-8PH (4)
- H-17573A Mylar Cowling Shim (order 2)
- H-17565D Line Guard
- H-17572A Fastener - M12 x 1.75-6G GC Screw
- H-17574A Mylar Guard Clamp Shim
- HFG310 Lower Toggle - 3/4" Clevis Pin
- HFG311 Lower Toggle - 7/8" Clevis Pin
- HFG351 Clevis Pin - 3/4" Lower Toggle
- HFG352 Clevis Pin - 7/8" Lower Toggle
- HFG344 Cotter Pin
- H-2715A Lock Nut
- HFG370 Lock Washer - Toggle
- HFG380 Flat Washer - Lower Toggle
- HFG621 Hub - w/o Lower Toggle
- HFG589 Tack Shackle Assembly
- HCP1513 Shackle - 10 mm Bow
- HFG588 Swivel Bracket w/Swivel Pin
- HFG589 Swivel Assembly
- HFG304 Clevis Pin - 3/8" X 1.500" 18-8
- HFS181 Cotter Pin - .094 x .750 18-8