

HARKEN®

INSTALLATION SHEET

Small Boat Control Blocks, Track and Trim Caps

Control Blocks: 2740, 2741, 2742, 2743
Track: 373, 374, 2720, 2721, 2725, 2751
Trim Caps: 2722, 2723

1251 East Wisconsin Avenue • Pewaukee, WI 53072 U.S.A.
Telephone: (262) 691-3320 • Fax: (262) 691-3008
Web: www.harken.com • Email: harken@harken.com

Read instructions before you cut or mount track

It may be necessary to put trim caps, control blocks and traveler car on track before mounting. Slide control assemblies onto track with bumper facing car. Keep control assembly loose so it can be moved out of the way while installing track.

Cut Track

To cut track to length, make sure stop holes for control blocks do not interfere with hole for mounting track. If necessary, cut both ends of track.

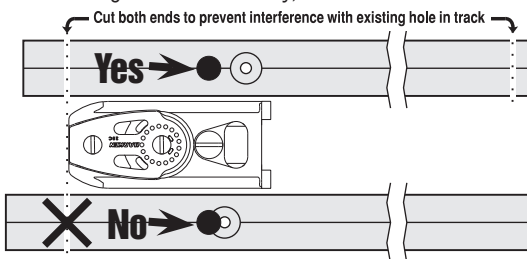

Cockpit Installation

To determine correct track length, make sure track ends, without trim caps, are $\frac{3}{4}$ " (19 mm) from edge of cockpit coaming.

Mount Track

Through-bolt track using #10 (5 mm) flathead screws. 2721 Track uses slide bolts, see instruction sheet for correct installation.

Install Control Blocks

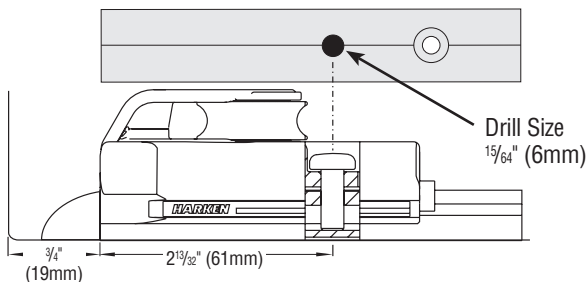

Position control block flush with end of track. Drive screw firmly against top surface to mark track, then loosen. Slide control block away.

IMPORTANT: Drill $\frac{15}{64}$ " (6mm) hole only through top surface of track.
Do not use screw hole in control block as drill guide.



373/2720/2751
Use 16mm Screws



2721
Use 20mm Screws



374/2725
Use 30mm Screws

Secure control block to track by tightening correct screw into hole.

Dead-ending Line at End Control



Install Trim Caps

Remove any burrs on edges of track. Press 2722 or 2723 trim caps in place.

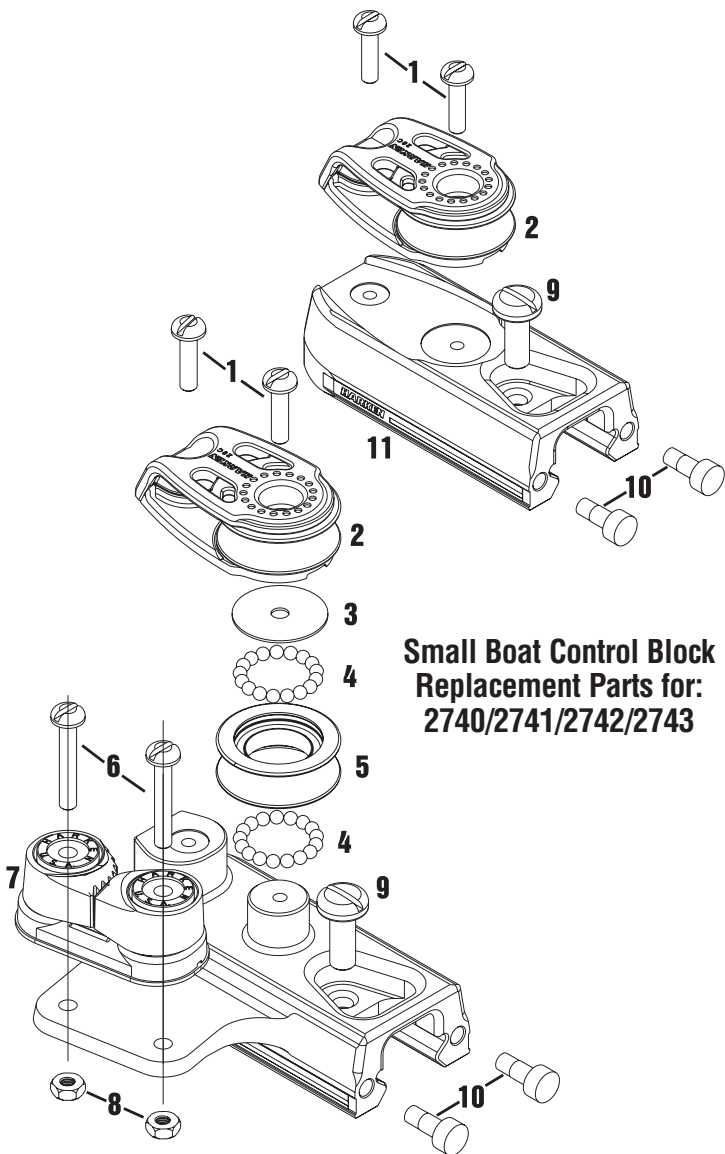

**Small Boat Control Block
Replacement Parts for:
2740/2741/2742/2743**

Control Block Replacement Parts

1	HFS963	Cheek Assembly Screws (2)	8	HFS890	Cam Assembly Nut (2)
2	350	Cheek Block	9	HSB376	Control Block Screw (Set)
3	H-32051A	Washer		HFS966	m6x1x16mm
4	HSB243	Bearings (34)		HFS967	m6x1x20mm
5	H-27771A	Sheave		HFS968	m6x1x30mm
6	HFS134	Cam Assembly Screws (2)	10	H-32054A	Control Block Bumpers (2)
7	423	Micro Cam Cleat	11	4965	Harken Label

Maintenance

Harken equipment is designed for minimal maintenance, but some maintenance is required to give the best service and to comply with the Harken limited warranty.

In general, the most important aspect of maintenance is to keep your equipment clean by frequently flushing with fresh water.

In corrosive atmospheres, stainless parts may show discoloration around holes, rivets and screws. This is not serious and may be removed with a fine abrasive.

With the exception of winches, do not use grease unless specifically recommended in the instruction sheets.

Important: Exposure to some teak cleaners and other caustic solutions can result in discoloration of part and is not covered under the Harken warranty.

Traveler Cars: Keep traveler cars clean by frequently flushing with fresh water. Periodically clean cars by squirting a detergent/water solution into the car's center openings. Roll the car back and forth to distribute evenly and then flush bearings with fresh water. This maintenance is very important, particularly when the cars haven't been in use.

Do not use spray lubricants because ball bearings may skid instead of roll. If you use a light machine oil such as 3-in-1, use only a single drop in each ball race. Too much oil attracts dirt.

Clean track with detergent and water.

Frequently inspect shackles and control block fittings for signs of fatigue. Make sure every installation includes Harken track end stops. Arrange control tackle so cars do not hit end stops under load.

Warranty

See Harken catalog for full maintenance and warranty information.